

IMC-750

Slide-In Modular Media Converter 10/100Mbps to Fiber Series



Features

- Variety of choices: multi-mode, single-mode, and single-strand fiber including SFP form factor
- Modular, hot-swappable architecture reduces operational costs associated with product installation, upgrades, and maintenance
- Provides modules with SFP transceivers that support extended operating temperature
- SNMP manageable
- Supports configuration control
- Supports Link Fault Pass Through (LFPT)

Introduction

The IMC-750/751 series are slide-in module Ethernet-to-fiber media converters for the IMC-7xx chassis, which support hot-swappable and easy installation. They allow network operators to incorporate multiple fiber types and wavelengths within a network. They can be monitored and controlled via a central site with the IMC-710 SNMP management module by iView², Telnet, or CLI while installed in a IMC-71x series chassis.

Link Fault Pass Through (LFPT) is a diagnostic feature that can enable or disable links to assist end users in troubleshooting a failed segment and configuration control to retain the latest configuration regardless of how the initial configuration was set up. The IMC-750 series can convert a 10/100 ~ 100Mbps copper-to-fiber media rate to auto-negotiation functionality on the twisted pair port for operation, and can fix it at 100Mbps copper-to-fiber with the IMC-751 series.

The IMC-751I-2SFP converter is protocol-independent with dual SFP ports which can provide a single conversion between different wavelengths or single-mode and multi-mode fiber, single-mode to single-mode fiber or multi-mode to single-strand single-mode fiber. The SFP port must use an SFP of the same speed while allowing for different fiber types. Additionally, the IMC-751I-2SFP is an industrial equipment device. The unit operates in environments that demand extended operating temperatures.

Specifications

Technical	
IEEE 802.3, 802.3u (IMC-750 series)	
IEEE 802.3 (IMC-751 series)	
SFP-MSA SFP standard (IMC-750I-SFP & IMC-751I-2SFP)	
Link Fault Pass-Through(LFPT)	
AutoCross for MDI/MDIX	
Supports LinkLoss and FiberAlert	
Supports GUI-Based iView ²	
Includes Diagnostic LEDs	
Includes Hot-swappable Architecture	
Meantime Before Failure (MTBF)	
MTBF	2.6 million hours (IMC-750 series)
	4.5 million hours (IMC-751 series)
	2.3 million hours (IMC-751I-2SFP)

Environment	
Operating Temperature	0 to +50 °C (+32 to +122 °F)
	-40 to +85 °C (-40 to +185 °F) (IMC-750I-SFP)
	-40 to +80 °C (-40 to +176 °F) (IMC-751I-2SFP)
Storage Temperature	-25 to +70 °C (-13 to +158 °F)
	-40 to +85 °C (-40 to +185 °F) (IMC-750I-SFP)
	-40 to +80 °C (-40 to +176 °F) (IMC-751I-2SFP)
Operating Humidity	5 ~ 95% (non-condensing)
	0 ~ 10,000 ft. altitude
Mechanical	
Dimensions (H x W x D)	10.74 x 2.0 x 7.05 cm (4.19 x 0.78 x 2.75 in)
Weight	0.11 kg (0.30 lb)
Certifications	
CE, FCC Class B	
UL, CSA, TUV (IMC-751I-2SFP)	

* Simple Network Management Protocol-based element management software. To configure, update, manage and monitor from a central location.



Dimensions

Unit: mm

IMC-750 series

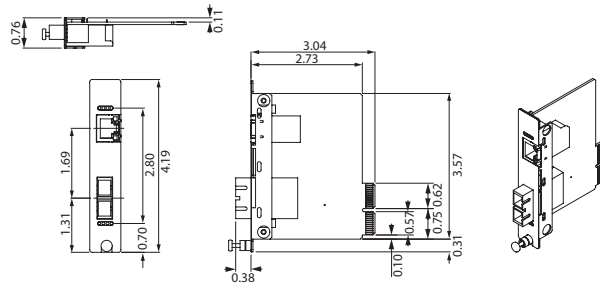

IMC-751 series

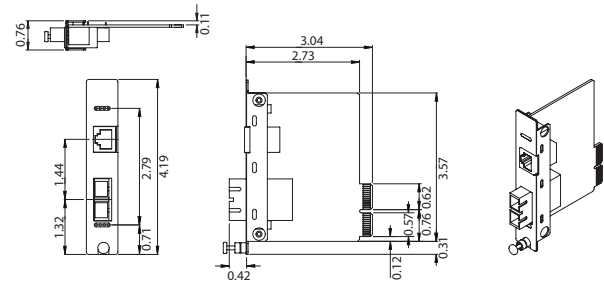

IMC-754I-SFP

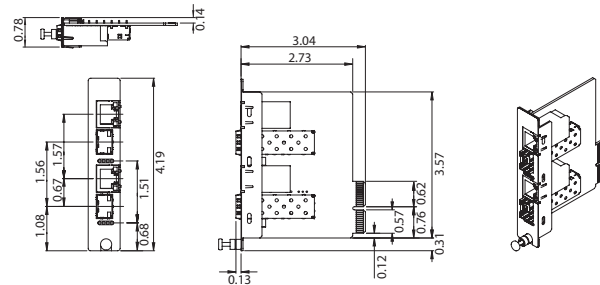

Ordering Information

Part Number	Also Known As	Ethernet Speed	Optical Mode	Wavelength	Distance	Optical Connector
IMC-750-SEST	856-15717	10/100Mbps	Single-Mode	1310nm	40 km	1 x ST
IMC-750-SE	856-15718	10/100Mbps	Single-Mode	1310nm	40 km	1 x SC
IMC-750-SST	856-15731	10/100Mbps	Single-Strand	1310T/1550R	20 km	1 x SC
IMC-750-SSR	856-15732	10/100Mbps	Single-Strand	1550T/1310R	20 km	1 x SC
IMC-750-SSET	856-15733	10/100Mbps	Single-Strand	1310T/1550R	40 km	1 x SC
IMC-750-SSER	856-15734	10/100Mbps	Single-Strand	1550T/1310R	40 km	1 x SC
IMC-750-SSLT	856-15735	10/100Mbps	Single-Strand	1310T/1550R	60 km	1 x SC
IMC-750-SSLR	856-15736	10/100Mbps	Single-Strand	1550T/1310R	60 km	1 x SC
IMC-750I-SFP (Wide-Temp.)	856-18700	10/100Mbps	Various	Various	Various	1 x SFP

Part Number	Also Known As	Ethernet Speed	Optical Mode	Wavelength	Distance	Optical Connector
IMC-751-M8ST	850-15611	100Mbps	Multi-Mode	850nm	2 km	1 x ST
IMC-751-M8	850-15612	100Mbps	Multi-Mode	850nm	2 km	1 x SC
IMC-751-MMST	850-15613	100Mbps	Multi-Mode	1300nm	5 km	1 x ST
IMC-751-MM	850-15614	100Mbps	Multi-Mode	1300nm	5 km	1 x SC
IMC-751-SE	850-15618	100Mbps	Single-Mode	1310nm	40 km	1 x SC
IMC-751-SST	850-15633	100Mbps	Single-Strand	1310T/1550R	20 km	1 x SC
IMC-751-SSR	850-15634	100Mbps	Single-Strand	1550T/1310R	20 km	1 x SC
IMC-751-SSET	850-15635	100Mbps	Single-Strand	1310T/1550R	40 km	1 x SC
IMC-751-SSER	850-15636	100Mbps	Single-Strand	1550T/1310R	40 km	1 x SC
IMC-754I-SFP (Wide-Temp.)	850-18610	100Mbps	Various	Various	Various	2 x SFP

* SFP fibers sold separately – available at www.advantech.com

* Single-Strand fiber deploys in pairs or connect another compatible single-strand fiber product.