

# NMC-6003L

## 1 or 2 Ports 100GbE QSFP28 Network Mezzanine Card



### Features

- 1 x Intel E810-CAM1 or E810-CAM2
- 1 or 2 ports QSFP28 connector
- 1 x PCIe x8, Gen4
- CE/ FCC, RoHS compliant



### Specifications

Controller	1 x Intel E810-CAM1 or E810-CAM2
Interface	1 x PCIe x8, Gen4
Speed	100GbE
Port	1 or 2 x QSFP28 Ports
LAN LED definition	<p>Link/Act LED/Bypass LED: Link: Green on Activity: Green Blanking LAN Bypass: NA Disconnect: NA</p> 
Advanced Software Features	<p>Teaming support IEEE 802.3ad IEEE 802.1Q VLANs IEEE 802.3 2005 flow control support Interrupt moderation</p>
OS Support	Linux (CentOS, Red Hat, Ubuntu), Windows server
Operating Conditions	<p>Operation: 0 ~ 40°C Storage: -40 ~ 70°C</p>
Power Voltage & consumption	<p>+12V ± 10% 15W</p>
Dimension (W x H x D)	74.6 x 42.4 x 174.7 mm
Compliance	CE/FCC, RoHS

### Ordering Information

Type	Part Number	Description
NMC	NMC-6003L-01FSA1	1 Port 100GbE QSFP28 Thumbscrew Type
NMC	NMC-6003L-02FSA1	2 Ports 100GbE QSFP28 Thumbscrew Type
Transceiver	NMC-TEL100S-00A1	100Gbps SR 850nm 70m/100m
Transceiver	NMC-TEL100L-00A1	100Gbps LR 1310nm 10km

### Front Panel Diagram

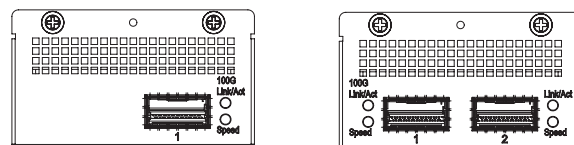

### Dimensions

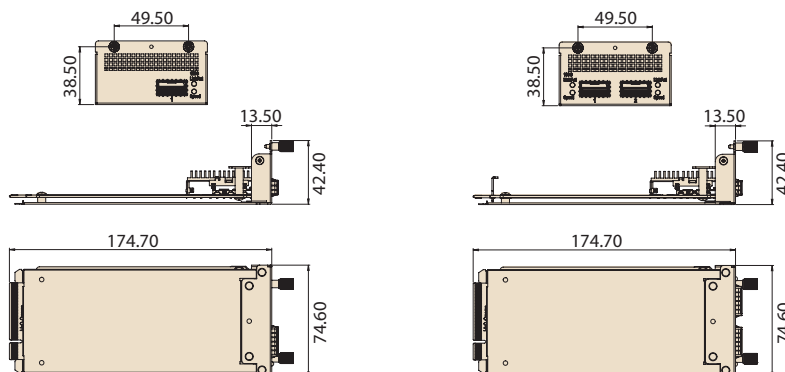

Unit: mm